

SW

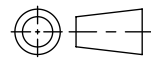

Revision level			Revision Record	Changed	Date	Approved	Date
Drawing	State	Part					
04.1	Design Release	-	SEE ECN# 016095	CAS	09/02/2020	GAL	09/02/2020

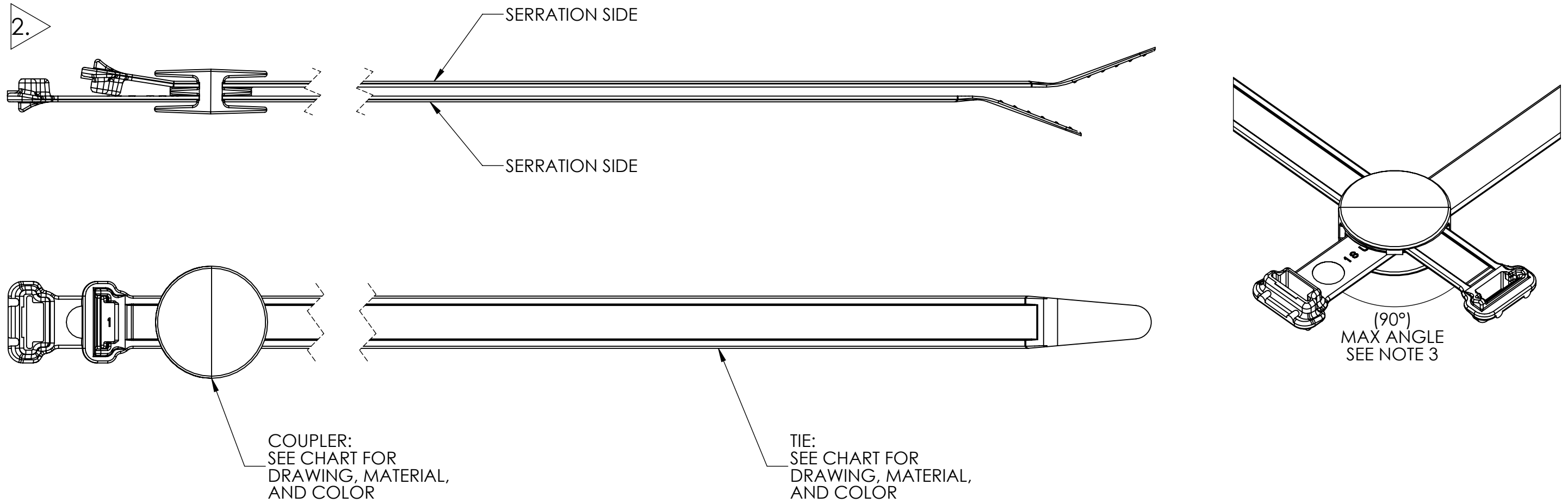

GLOBAL PART DESCRIPTION	BUNDLE RANGE	CABLE TIE			COUPLER		
		DRAWING	MATERIAL	COLOR	DRAWING	MATERIAL	COLOR
DUALWSRASSY-PA66HIRHSUV-BK	15mm to 98mm	CT2127004CST	PA66HIRHSUV	BLACK	19-1754-001-CSU	PA66HIRHSUV	BLACK

- Notes
- DELIVERY CONDITION: 2 CABLE TIES AND 1 COUPLER ASSEMBLED.
 - SEE VIEW ABOVE FOR ASSEMBLY ORIENTATION.
 - CABLE TIE ANGLE NOT CONTROLLED IN ASSEMBLY.

Material
SEE CHART

Units: millimeters
Dimension without tolerances details to:
.xxx = ±.013
.xx = ±.13
.x = ±.3
None = ±.8
∠ = ±0.5°
Dimension Formatted mm/[in]

The copyright of this drawing is reserved by HellermannTyton. It is issued on condition that it is not reproduced, copied, or disclosed to a third party, either wholly or in part, without the consent of HellermannTyton.

Drawn CAS 03/25/2020
Approved GAL 03/25/2020
HellermannTyton
North America
Email: corp@htamericas.com
Web: www.hellermann.tyton.com

Article/Type-No DUALWSRASSY
Title ASSEMBLY OF WIDE STRAP SWIVEL COUPLER AND T120 WIDE STRAP TIE
Drawing-No 20-0133-001-CSU
Production : Phase

Scale 1:1
Project Number PRP20-0133
Format B
Sheet 1/1