

Isometric view

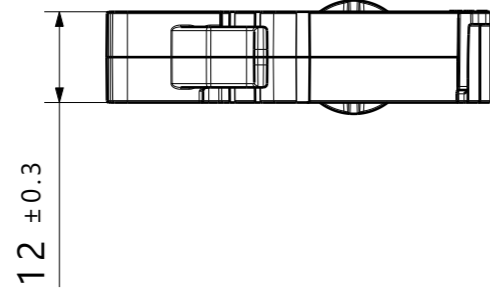

12 ± 0.3

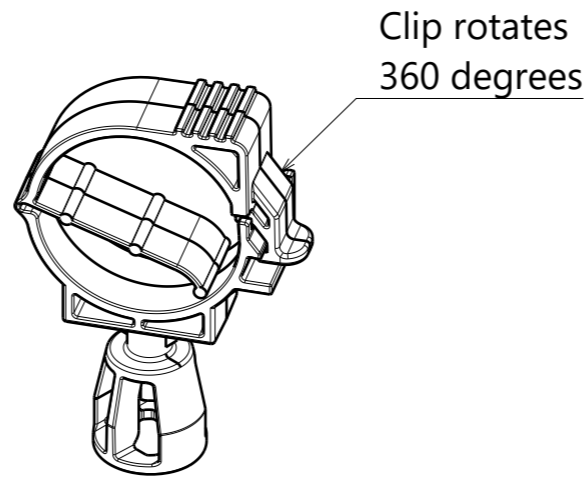

Isometric view
Closed & rotated

Clip rotates
360 degrees

Reference:

Performance requirements at dry as molded:

1. Stud mount push on force: 45 newtons (10 lbf) max on each applicable stud size.
2. Stud mount pull off force: 110 newtons (25 lbf) min on each applicable stud size.

Notes:

1. Material: See chart
2. Material color: See chart
3. Maximum percent regrind permissible: 25%
4. Max allowable flash to be: 0.25mm
5. Max allowable mismatch to be: 0.1mm
6. Applicable stud size:
 - A. M5 x 0.8
 - B. T5
 - C. M6 x 1
 - D. T6

* Recommended sizes may differ depending on the application, product requirements, and materials used.

** Rotational orientation of clips upon delivery is not controlled

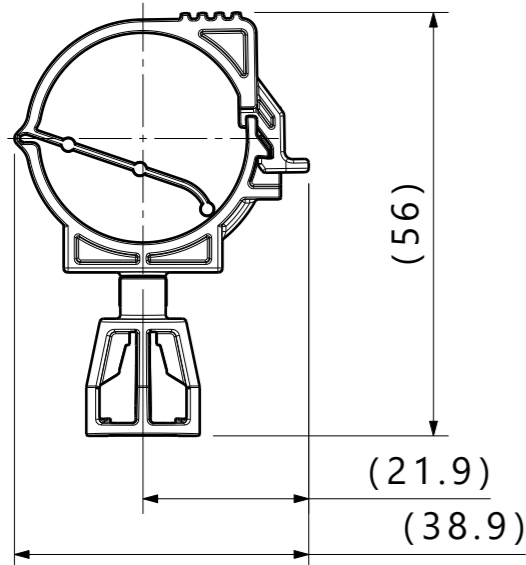
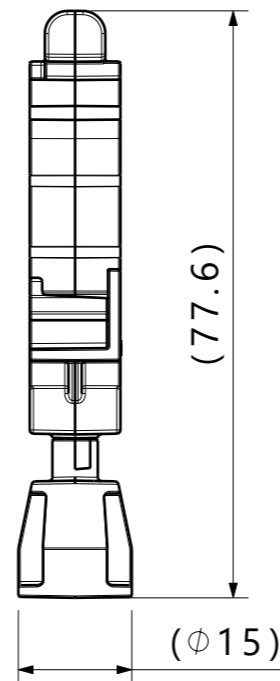
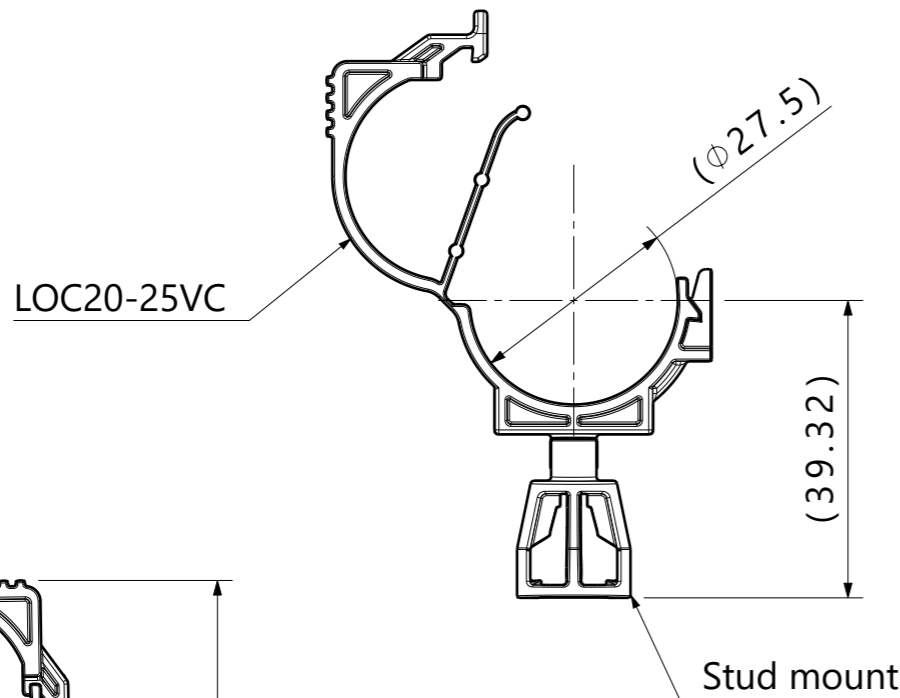

LOC in closed position

Diameter Range*		
Harness	Soft tube/Hose	Pipe, Hard tube/ Hose, Cable
20.0mm-25.0mm	20.0mm-25.0mm	21.0mm-25.0mm

Global Part Description	LOC20-25VC			Stud Mount		
	Drawing	Material	Color	Drawing	Material	Color
SMFLOC20-25VC-PA66HIRHSUV-BK	12-0631-051-CSU	PA66HIRHSUV	Black	19-0295-001-CSU	PA66HIRHSUV	Black

Revision Level			Revision Record		
Drawing	State	Part	ECN 016566		
00.2	Design Release	-			
Changed	Date (YYYY/MM/DD)				
Klos	2021/09/22				
Approved	Date (YYYY/MM/DD)				
Karabon	2021/09/22				

The copyright of this drawing is reserved by HellermannTyton.

All drawing revisions are stored in CAD PDM database

Units: mm

Drawn: Klos, Date: 2021/09/22

Approved: Karabon, Date: 2021/09/22

HellermannTyton
www.HellermannTyton.com

Title: LOC20-25VC coupled with a M5/M6 stud mount

Scale: 1:1

Global Project Number: 19-1665

Format: A3

Sheet: 1 / 1

Drawing-No: **19-1665-001-CSU**